

abbotFox



Hillside, Cromer

Guide Price £300,000

“

We are a team of genuine individuals who hold a deep passion for both property and marketing. Collectively, we bring over 70 years of experience in the property market of Norfolk and Suffolk. Our affection for both counties runs deep, and we are enthusiastic about sharing our passion with you.

Colin McKenzie | **Branch Partner**







THE DETAIL _____

abbotFox presents this chain free property, which is perfectly positioned on the edge of Cromer. This detached two bedroom bungalow offers a unique blend of coastal convenience and woodland tranquillity. Set within a quiet residential location and siding onto picturesque woodland, this charming home provides an ideal retreat while remaining within easy reach of the town's award-winning beaches, independent shops, and vibrant café culture.

The internal accommodation is neatly arranged and offers an inviting porch, hallway, lounge, kitchen breakfast room, dining room, which could be converted to a third bedroom, two further double bedrooms and a family bathroom.

The private rear garden, sides onto the woodland, and offers a peaceful escape ideal for those who appreciate nature on their doorstep. Whether enjoying alfresco dining on the patio or simply unwinding in the tranquil surroundings, this outdoor space truly enhances the home's appeal. Cromer's bustling town centre is just a short distance away, offering a range of local amenities, excellent transport links, and the stunning Norfolk coastline.

An internal viewing comes highly recommended.

Guide £300,000 - £325,000







THE HIGHLIGHTS _____

- No onward chain
- Detached bungalow
- Two / three bedrooms
- Private gardens siding woodlands
- Generous living accommodation
- Sought after location
- Viewing advised

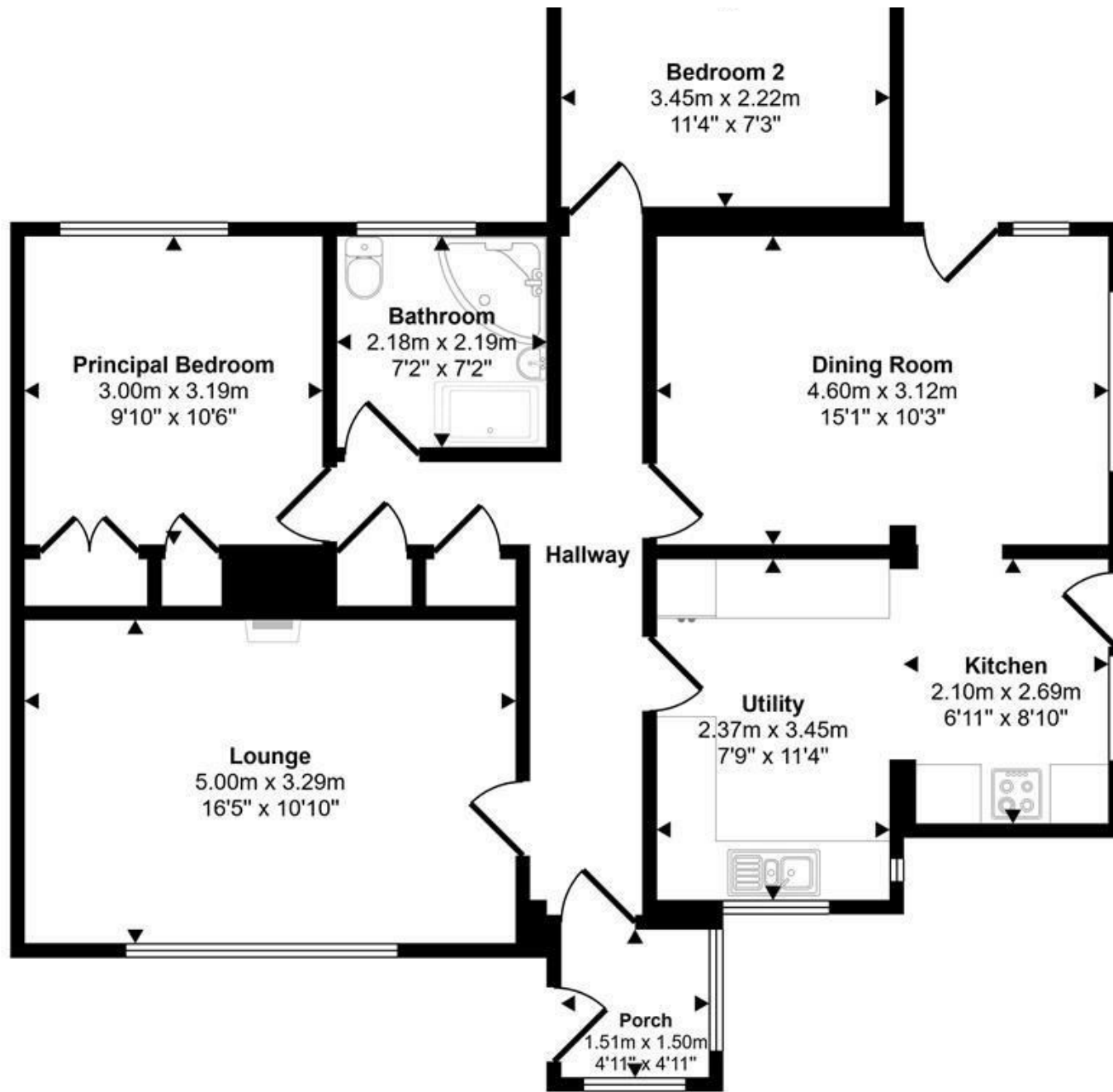

Let's talk

01603 660000

sales@abbotfox.co.uk

@abbotfox

EPC RATING -

Disclaimer – In accordance with the Property Misdescriptions Act, the company abbotFox gives notice that all descriptions, references to condition, necessary permissions for use and other details are given in good faith and believed to be correct, but any purchaser should not rely on them as statements of fact, and must satisfy themselves by inspection or other means, as to their accuracy.